

CALL POINT MANUAL

Technical parameters:

Working Voltage	24VDC
Max. Current	1A @24VDC
Contact Resistance	$\leq 0.02\text{ohm}$
Working Conditions	Temp. $-10\sim+65\text{ }^{\circ}\text{C}$ Humidity: 10%~90%RH

Instruction and wire connection as below:

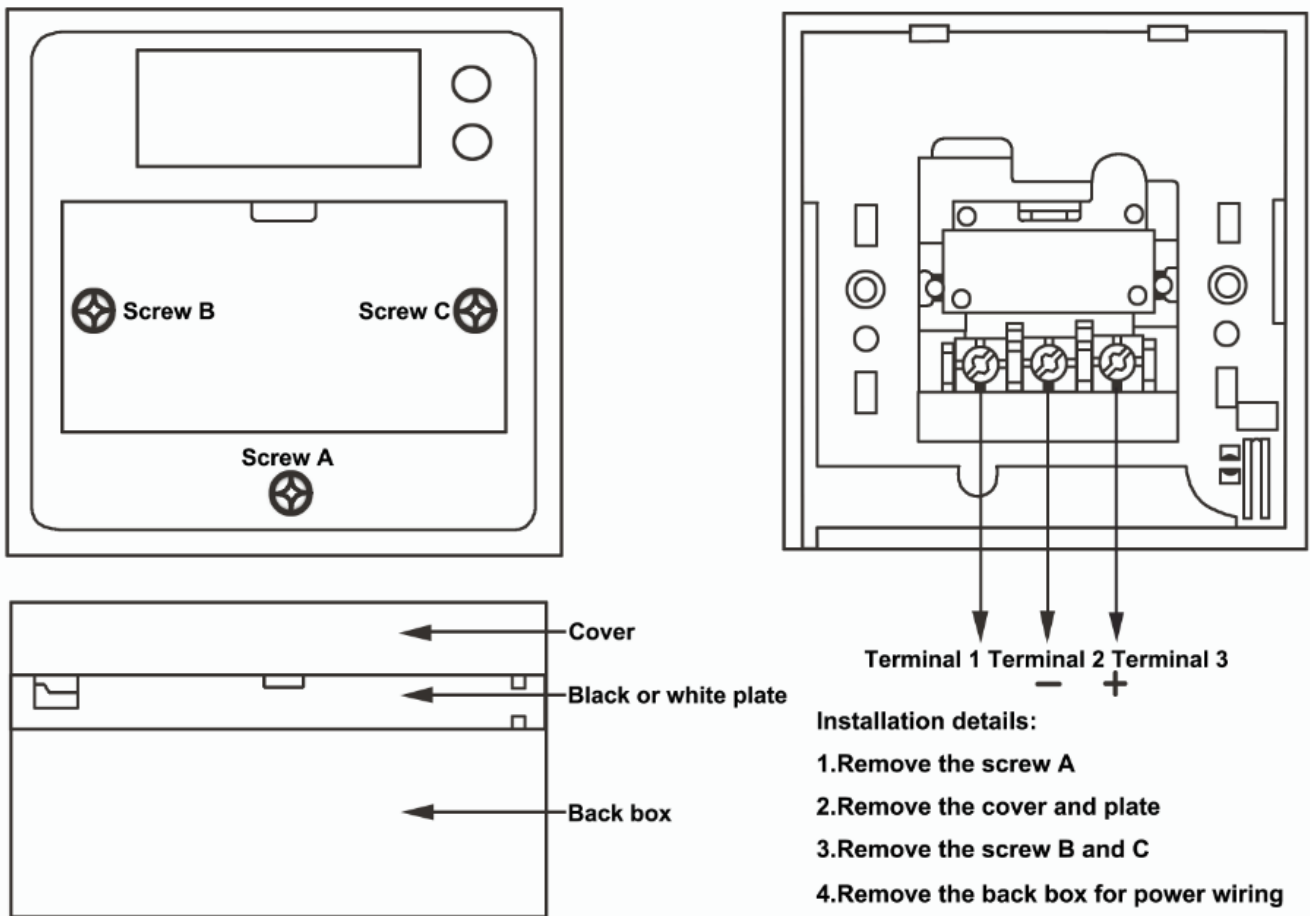

Remark:

1. For LED indicator device, the green indicator for normal working state; the red LED indicator for alarming state
2. You should put resistance ($330\text{ ohm} < R < 3\text{K ohm}$) at the terminal of the 1 and 3, normally, we put 470 ohm in advance.